

*The Carlyle*  
at Bay Colony

**Plan B North**

A/C Living Area	2,635 Sq. Ft.
Terrace	484 Sq. Ft.
<b>Total Residence</b>	<b>3,119 Sq. Ft.</b>

All dimensions and square footage totals are approximate and may vary slightly with the actual construction.

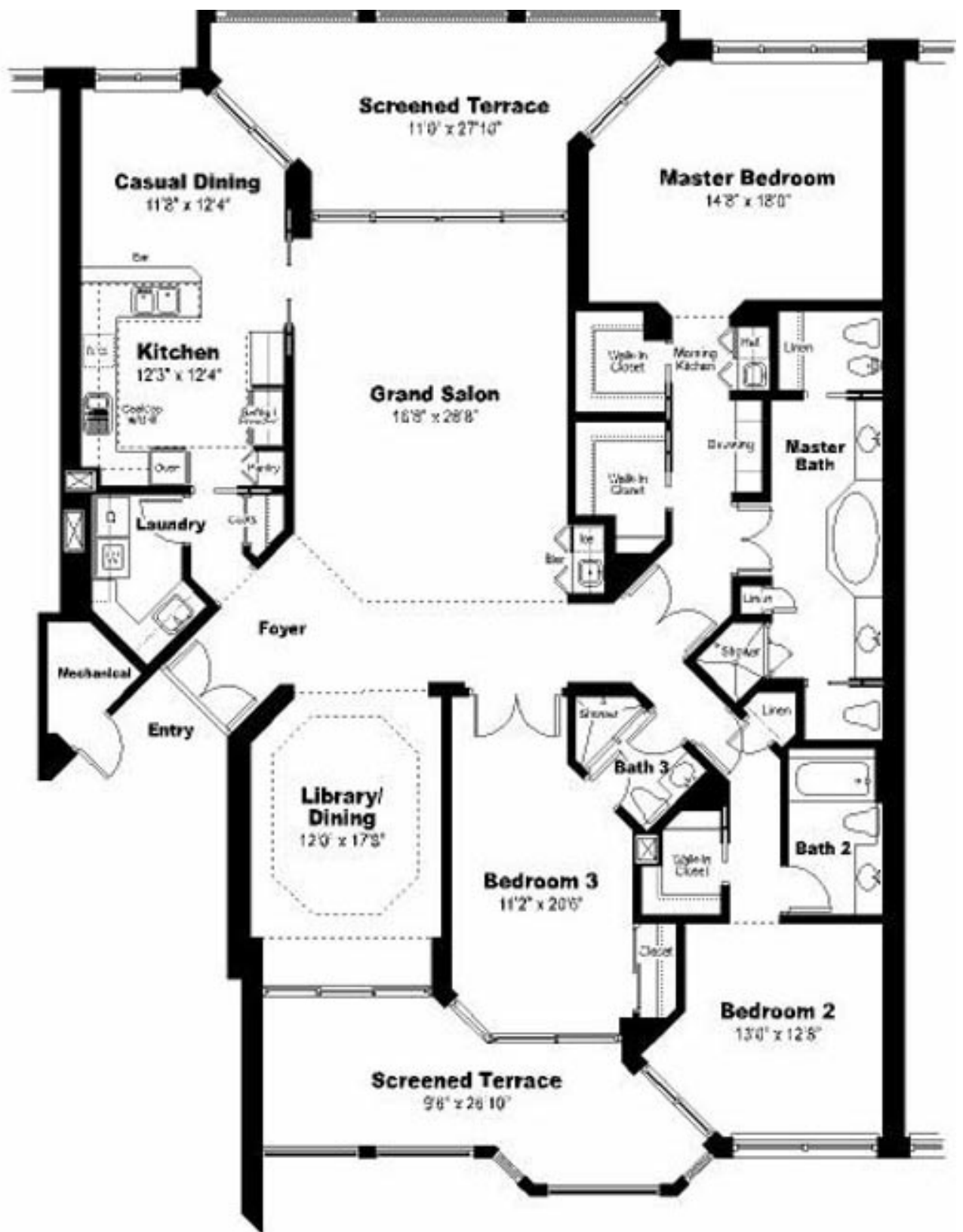

*The Carlyle*  
at Bay Colony

Plan B South

A/C Living Area	2,635 Sq. Ft.
Terrace	484 Sq. Ft.
<b>Total Residence</b>	<b>3,119 Sq. Ft.</b>

All dimensions and square footage totals are approximate and may vary slightly with the actual construction.



*The Carlyle*  
at Bay Colony

Plan A North

A/C Living Area	3,274 Sq. Ft.
Terrace	761 Sq. Ft.
<b>Total Residence</b>	<b>4,035 Sq. Ft.</b>

All dimensions and square footage totals are approximate and may vary slightly with the actual construction.