

**Left**  
2nd Floor

**Right**  
2nd Floor

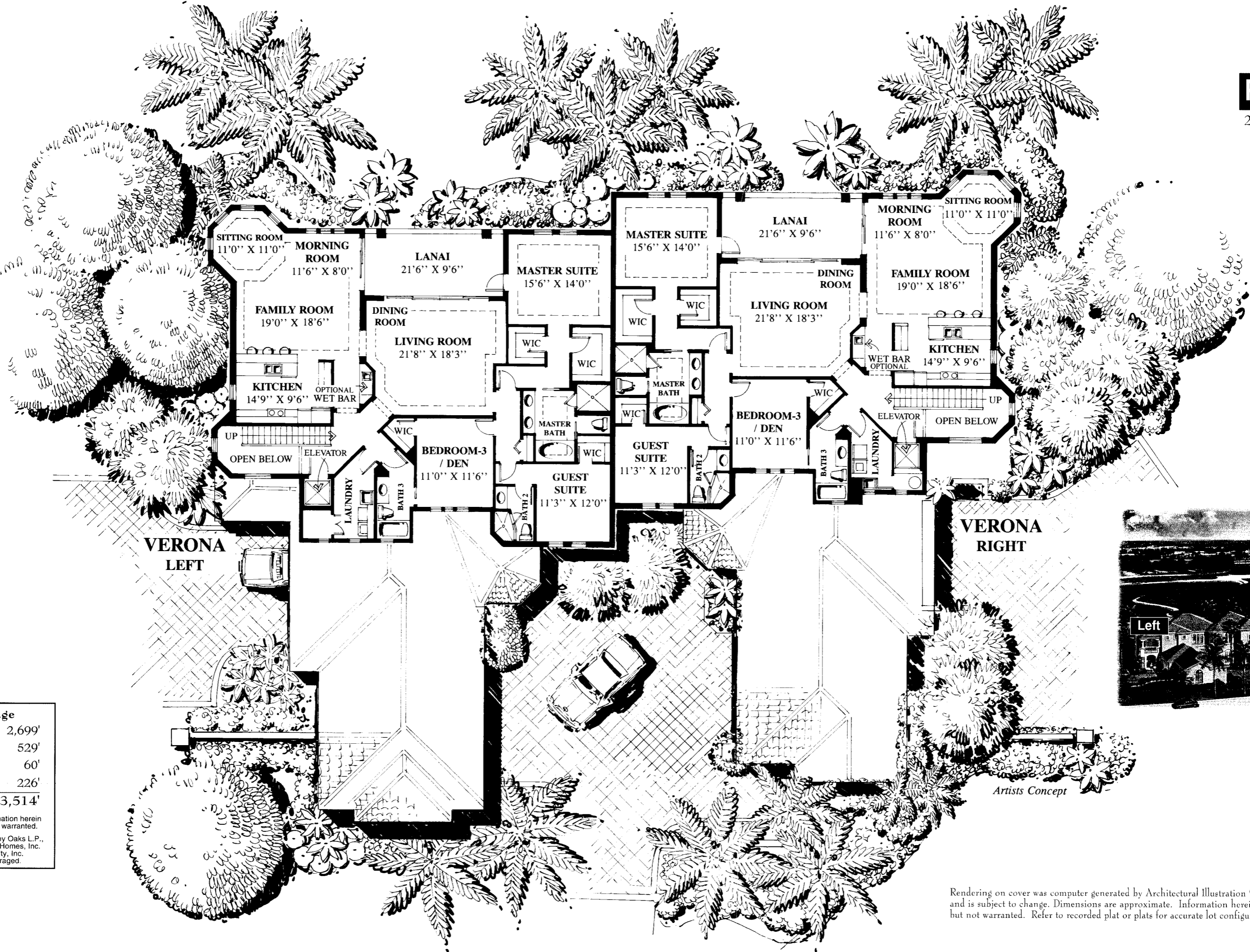

| Square Footage |               |
|----------------|---------------|
| Living Area:   | 2,699'        |
| Garage:        | 529'          |
| Entry:         | 60'           |
| Lanai:         | 226'          |
| <b>Total:</b>  | <b>3,514'</b> |

Dimensions approximate. Information herein believed to be accurate but not warranted.  
Developed by Terra Verde at Grey Oaks L.P., and constructed by Florida Bay Homes, Inc. Offered by Grey Oaks Realty, Inc. Broker participation encouraged.



Artists Concept

Rendering on cover was computer generated by Architectural Illustration ©Art Associates, Inc., and is subject to change. Dimensions are approximate. Information herein believed to be accurate, but not warranted. Refer to recorded plat or plats for accurate lot configuration and dimensions.