

THE ENVOY 3

Standard Luxury Features

- Concrete Block with Integrated, 16" Reinforced Concrete Tie Beam with Heavy Steel Bars
- Monier or Lifestile Concrete Roof Tiles in Standard Colors of Your Choice.
- Slick Finish Walls to Allow Any Kind of Decorator Finish.
- All Copper Water Lines; Kohler Fixtures; Delta Faucets; European Kitchen Sinks; Two Hot Water Heaters, Bidet in Master Bath.
- Jenn-Aire Appliances Throughout; Separate Range and Grill With Custom-Designed Range Hood.
- Your Choice of Premium Foil Cabinetry Doors or Natural Wood in Choice of Select Colors, Corian Counter Tops in Kitchen.
- Premium Sherwin-Williams Interior and Exterior Paints With High-Scrub Warranty.
- High Efficiency (11.0 Seer) Trane HVAC Heating and Cooling Equipment.
- 200-Amp Electric Service, Ceiling Fans in Every Room; Dedicated Computer Circuits in Study; Pre-wired Security System Ready for Monitoring Service.
- Generous Allowance Provided Enable Ceramic Tile in Main Living Area and Quality Carpets in Bedroom Areas.
- Quality Schlage Locks in Classic Bar Handle Styling; Dead Bolts on All Exterior Doors; Garage Door Openers.
- 8-Foot Room Entry Doors, Steel Front Entry System With Magnetic Locking Weatherstripping and Brass Inlaid Glass.
- Copyrighted Tub and Shower Design in Master Bedroom.
- Two-Car Garage plus Golf Cart Space Offered as an Option.
- Laundry Room With Folding Tables.
- Maximized Views of Pool Area and Golf Course.
- A Complete List of Options Is Available, Including Custom-Designed Pools and Spas.

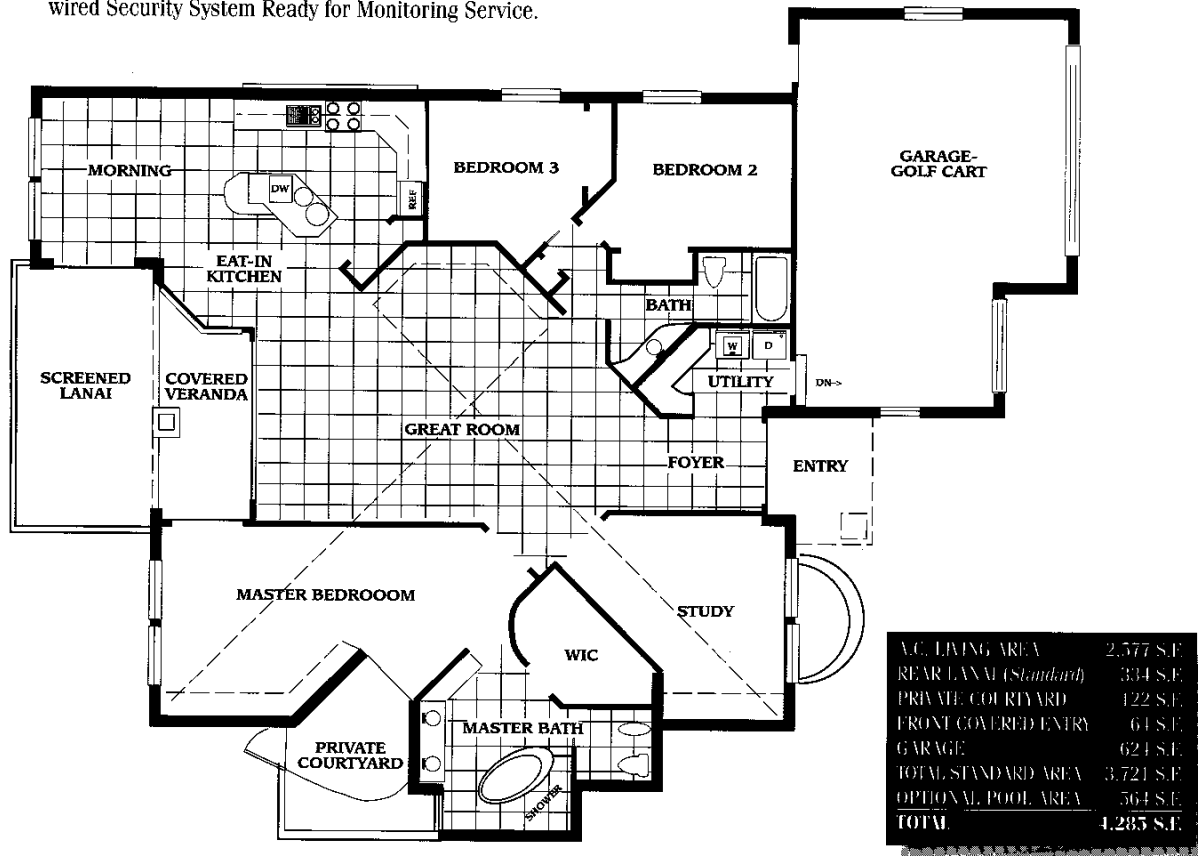

All dimensions, features and specifications are approximate and subject to change and or field variations.

ORAL REPRESENTATIONS CANNOT BE RELIED UPON AS CORRECTLY STATING REPRESENTATIONS OF THE DEVELOPER. FOR CORRECT REPRESENTATIONS, MAKE REFERENCE TO THIS BROCHURE AND TO THE DOCUMENTS REQUIRED BY SECTION 718.503, FLORIDA STATUTES, TO BE FURNISHED BY A DEVELOPER TO A BUYER OR LESSEE.