

W I N D S T A R

ON NAPLES BAY

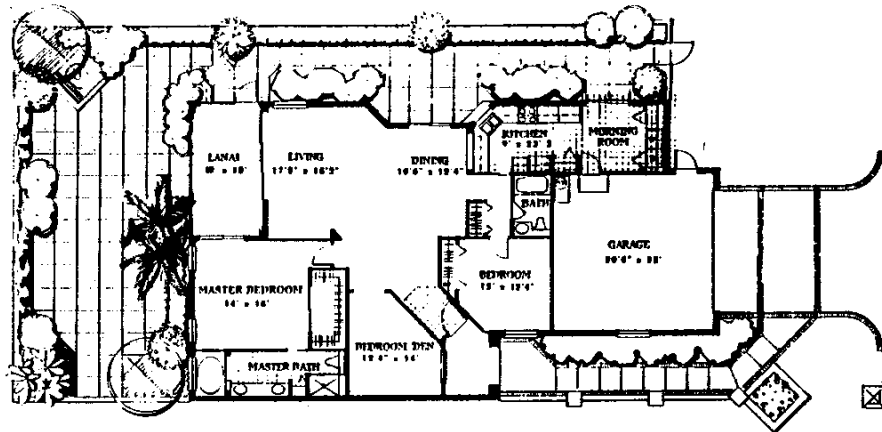

The Celebrity
3 Bedroom/Den, 2 Bath
LIVING AREA 1,833 Sq. Ft.
LANAI 180 Sq. Ft.
GARAGE 451 Sq. Ft.
TOTAL 2,464 Sq. Ft.

Address: Somerset — The Celebrity Paget Circle, Unit #	Bedrooms: 3/Den Baths: 2	Price \$189,900 - \$224,900
---	-----------------------------	--------------------------------

Own's Name	W S Realty, Inc.	Sq. Ft. L.A.	1833	Living Rm.	17'8" x 16'3"
Taxes		Sq. Ft. T.A.	2464	Dining Rm.	10'6" x 12'4"
Homestead	No	Construction	CBS	Kitchen	8'9" x 15'6"
Year Built	1989 / 1990	Lot Size	As per plat	Bkfst. Nook	8'9" x 8'5"
Maintenance	2 qtr. \$689	View	Lake / Golf / Courtyard	Bedroom 1	14'0" x 16'0"
Financing	*See below	Roof	Concrete tile	Bedroom 2	12'0" x 12'4"
Possession	At closing	Stories	1	Bedroom 3/Den	12'4" x 14'0"
Appliances	Range / Oven	Parking	2-car garage	Utility Rm.	Yes
	Dishwasher / Refrigerator	Floor Cover	N/A	Lanai	10'0" x 18'0"
	Washer / Dryer	Windows	Aluminum	School District	Lely High School
	A/C / Heater	Draperies	N/A		Gulfview Middle
Water	City	Pool	Community		Avakon Elementary
Sewer	County	Spa	Community hot tub	Lease Restrictions	3 times per year, 30 days min.
Zoning	Multi-family — alt. villa		Home owners assoc.		

Special Features/Additional Copy:
 *Special financing: 5% down, no points, to qualified buyers.

All information and specifications obtained from sources deemed to be reliable but are not guaranteed by W S Realty, Inc. Buyer should consider using an inspection service company to inspect the condition of the premises. The dimensions, sizes, configurations and other information contained on this drawing are approximate and meant to be illustrative only.

Lodestone Realty Mgmt., Inc. Licensed Real Estate Brokerage