

Features

IN YOUR BUILDING

- Underbuilding parking for each unit; additional covered and uncovered parking for guests.
- Two elevator stacks that each serve only two units per floor for enhanced privacy and security.
- Private pool and deck adjacent to marina slips along the western island perimeter.
- Air conditioned storage space for each residential unit.
- Fire sprinklers throughout building common areas and all units for safety.
- Private secured building entry with guest access controlled by homeowner.

IN YOUR HOME

- Unobstructed expansive western water views from each unit.
- Ceiling heights rise to nine feet in major living spaces.
- Floor-to-ceiling sliding glass doors and large open terraces provide significant sunlight for main living and master bedroom areas.
- Oversized master bathroom area with large whirlpool tub, walk-in shower and private commode.
- Secondary bedroom suites include a private bath.
- Marble tub surround and shower walls in master bath with cultured vanity. Secondary baths include full ceramic tile (flooring, shower and/or tub surround) and cultured marble vanity or pedestal sink.
- European-style cabinetry throughout kitchen area.
- GE "Profile" series, white-on-white appliance package. Center island and large pantry included in each kitchen.
- Full sized utility room equipped with large washer/dryer, cabinets and sink.
- Dual zone air conditioning with humidistat, 80 gallon water heater standard in each unit.
- Mechanical rooms accessible from common area for added privacy/security.
- Wood shelving in all bedroom closets. Master bedroom closet includes double shelves.
- Crown molding in living room, dining room, and bedroom suites (primed).
- Raised panel doors (primed).
- 5 1/4" baseboards throughout all main rooms (primed).
- Terrace areas pre-wired for optional hurricane shutter installation.

Optional Bedroom 4

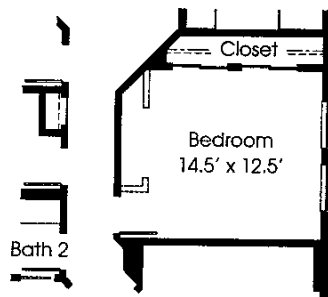

Admiral

Living Space	2862 ac sf
Terrace	277 sf
Total	3139 sf

The Admiral