

MANCHESTER V

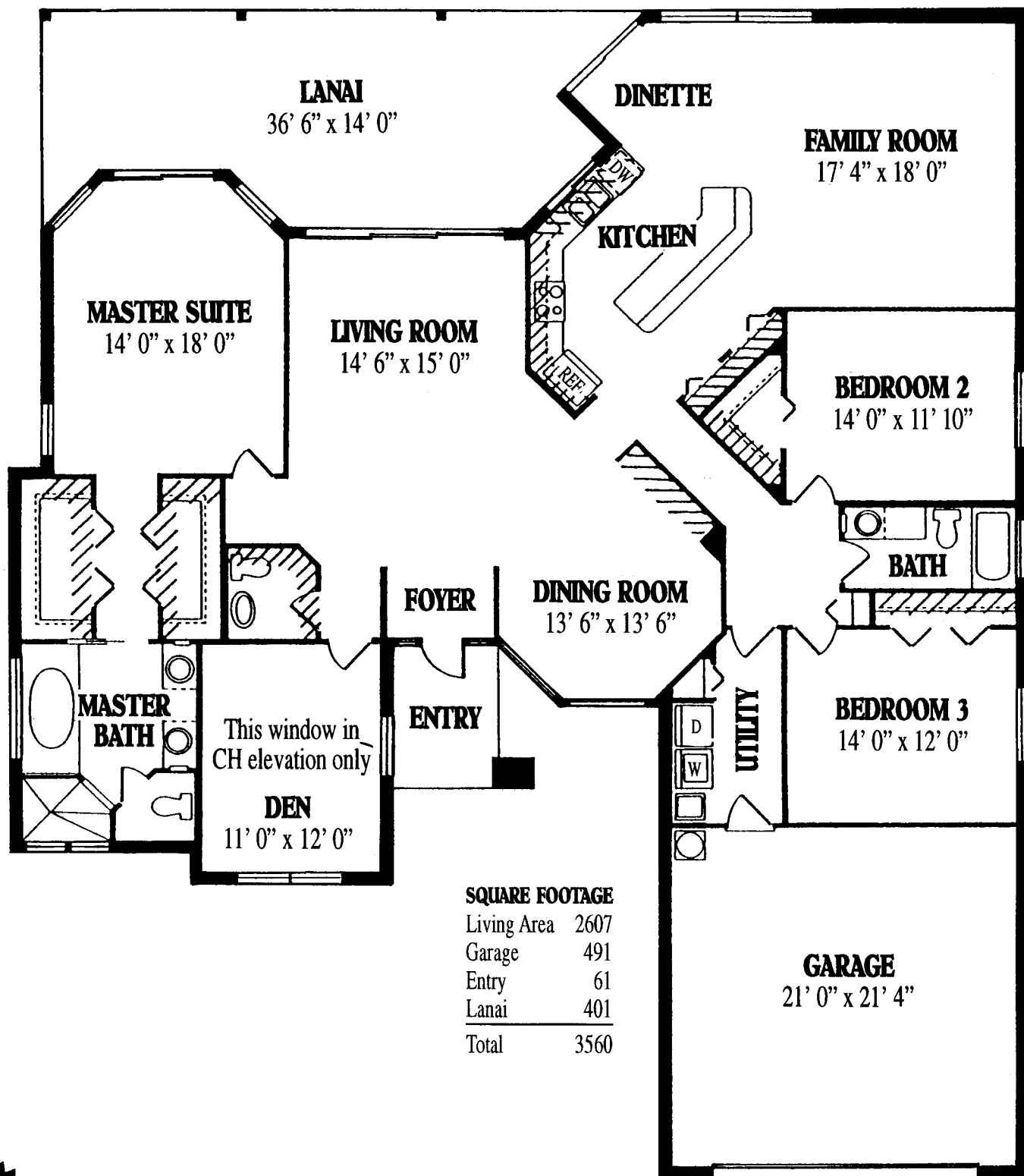

A view to the outdoors is guaranteed from every room in the Manchester floor plan. The master suite has impressive space and light from its large bay window, along with oversized windows above the master bath tub and in the shower. An octagon shaped dining area is ideal for entertaining. Angled walls throughout give the Manchester a uniqueness all its own. An elaborate plan, with rooms that flow together, make this a perfect place to come home to.

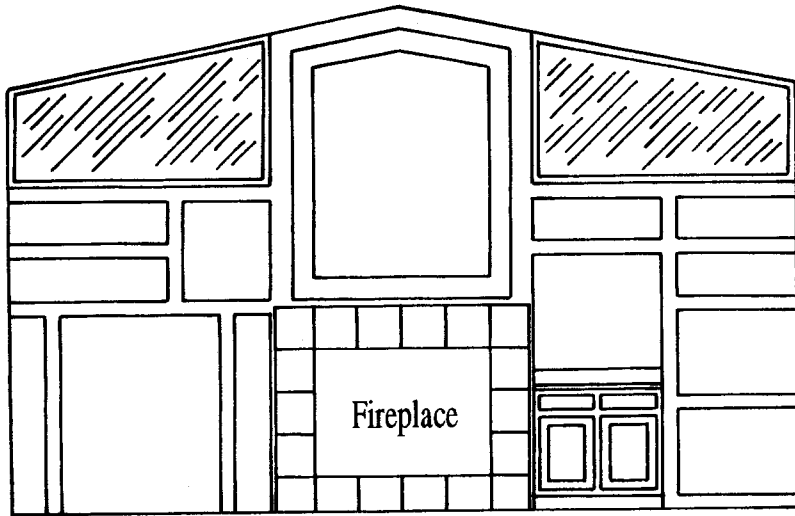



BUILT-IN WITH FIREPLACE IN FAMILY ROOM
 (Available only with Cathedral Ceiling)

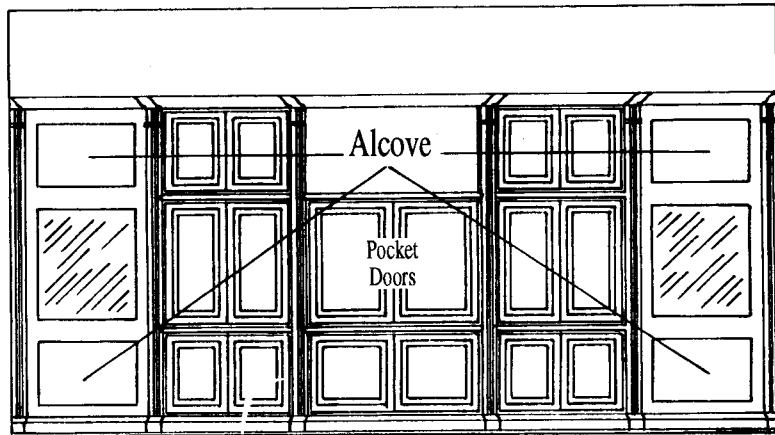
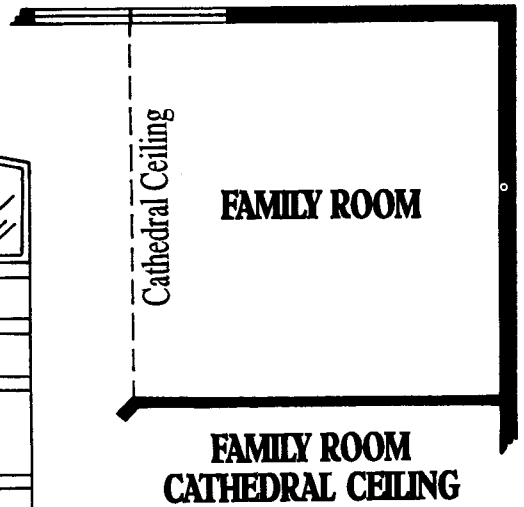

ENTERTAINMENT CENTER IN FAMILY ROOM

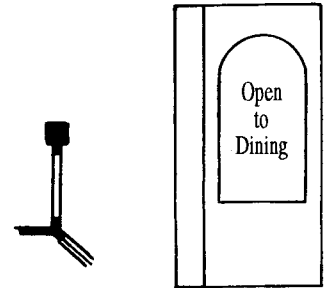

**12" x 12" COLUMN
 AT FOYER & OPENING
 TO DINING ROOM**

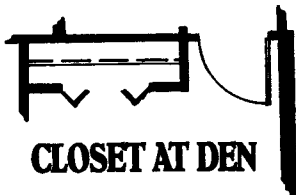

CLOSET AT DEN



**DOUBLE
 ENTRY DOORS**



BAY WINDOW AT DEN
 Additional Living Area 21' sq. ft.

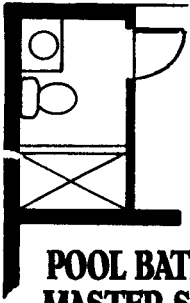

**POOL BATH AT
MASTER SUITE**



**POOL BATH AT
FAMILY ROOM REAR**



FAMILY ROOM BAY WINDOW
Additional Living Area 34' sq. ft.

**POOL BATH AT
FAMILY ROOM SIDE**

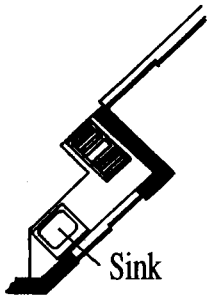
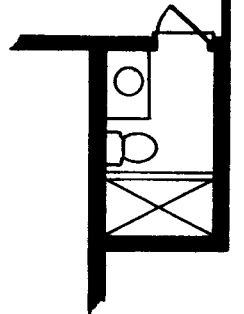

**OUTDOOR
COOK CENTER**

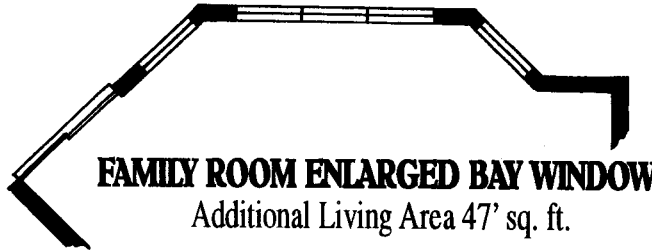

FAMILY ROOM ENLARGED BAY WINDOW
Additional Living Area 47' sq. ft.

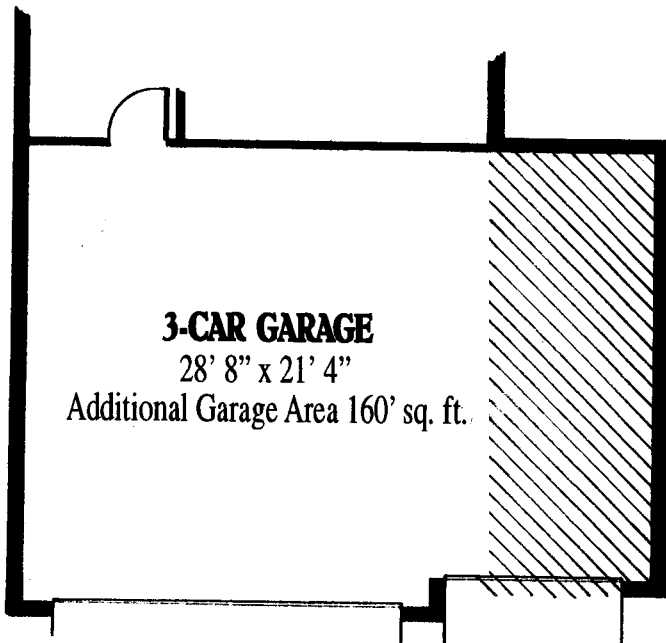

3-CAR GARAGE
28' 8" x 21' 4"
Additional Garage Area 160' sq. ft.

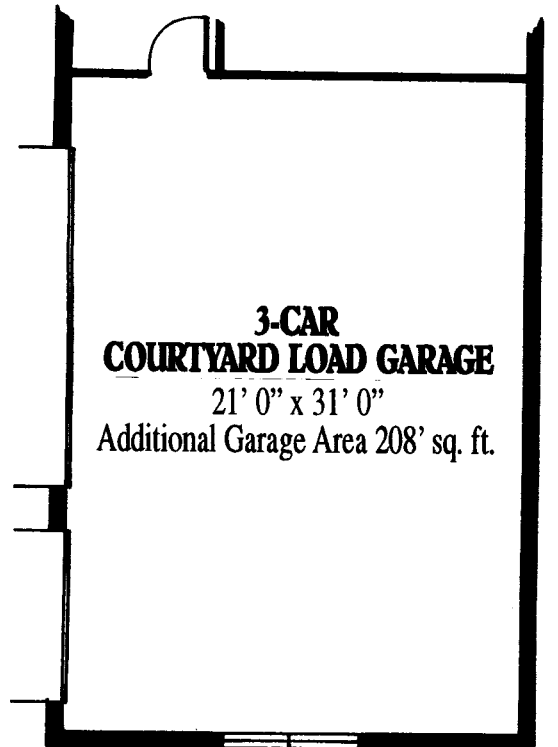

**3-CAR
COURTYARD LOAD GARAGE**
21' 0" x 31' 0"
Additional Garage Area 208' sq. ft.

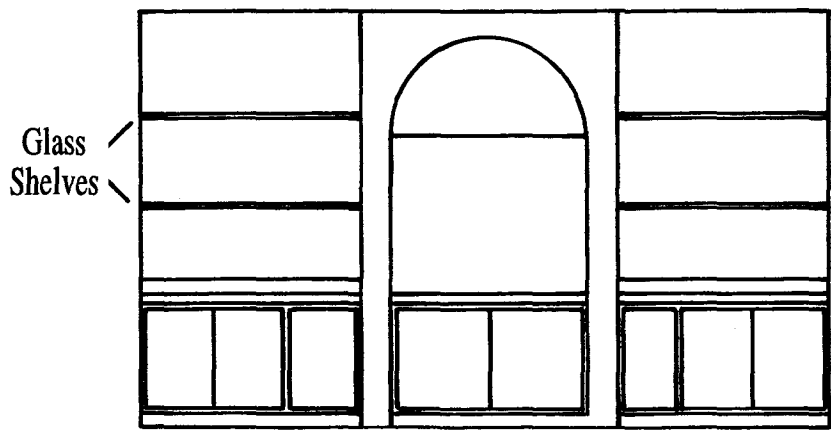

BUILT-IN ENTERTAINMENT CENTER IN FAMILY ROOM

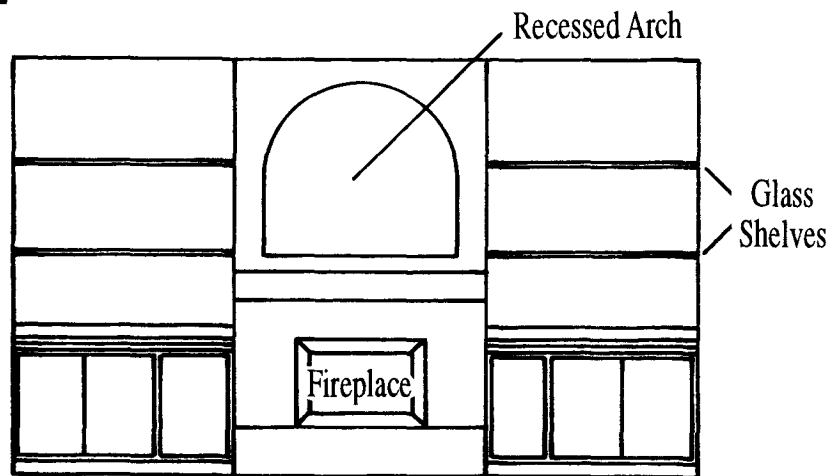
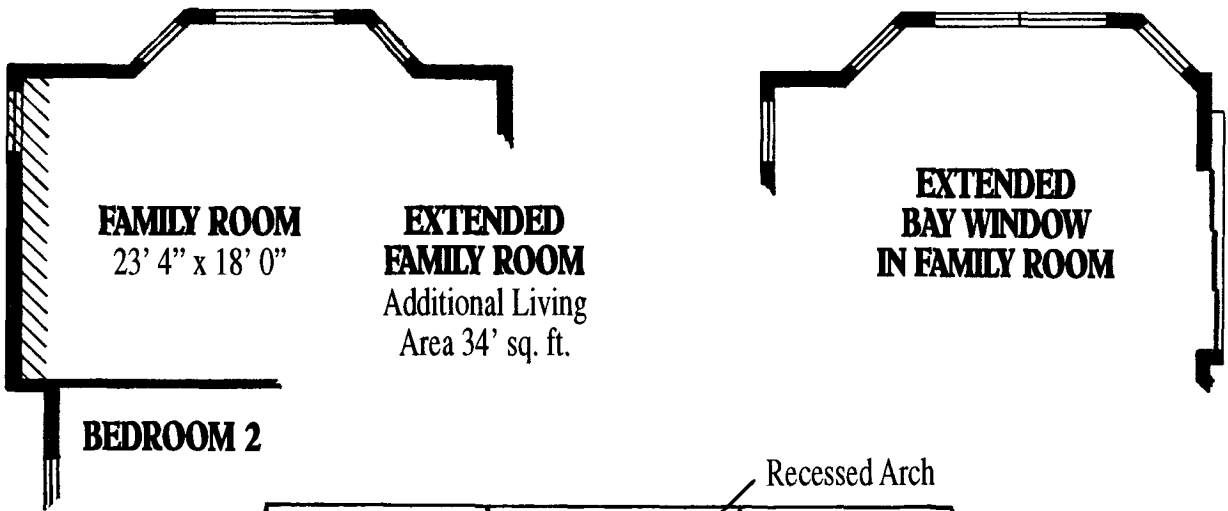

BUILT-IN WITH FIREPLACE IN FAMILY ROOM