

THE ARBORS IS A SPECIAL NEIGHBORHOOD AT PELICAN MARSH NAMED FOR ITS PRIZED LOCATION BESIDE THE COCOHATCHEE STRAND, A NATURAL PRESERVE AND HABITAT FOR NATIVE VEGETATION AND WILDLIFE.

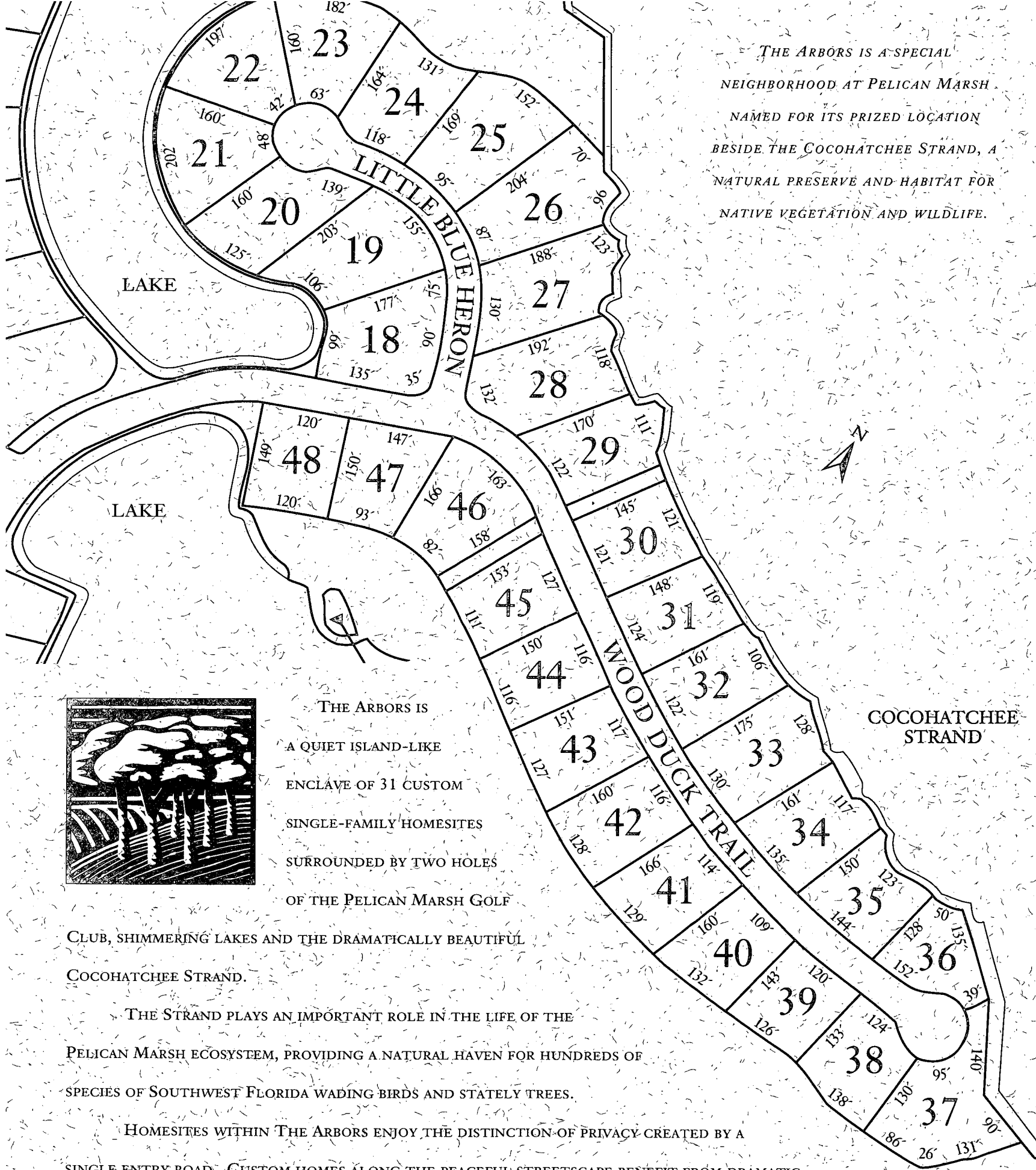

THE ARBORS IS A QUIET ISLAND-LIKE ENCLAVE OF 31 CUSTOM SINGLE-FAMILY HOMESITES SURROUNDED BY TWO HOLES OF THE PELICAN MARSH GOLF

CLUB, SHIMMERING LAKES AND THE DRAMATICALLY BEAUTIFUL COCOHATCHEE STRAND.

THE STRAND PLAYS AN IMPORTANT ROLE IN THE LIFE OF THE PELICAN MARSH ECOSYSTEM, PROVIDING A NATURAL HAVEN FOR HUNDREDS OF SPECIES OF SOUTHWEST FLORIDA WADING BIRDS AND STATELY TREES.

HOMESITES WITHIN THE ARBORS ENJOY THE DISTINCTION OF PRIVACY CREATED BY A SINGLE ENTRY ROAD. CUSTOM HOMES ALONG THE PEACEFUL STREETScape BENEFIT FROM DRAMATIC GOLF COURSE, WATERFRONT AND PRESERVE LOCATIONS.