

Residence Four

Enclosed area: 2250 sq. ft.
Balcony area: 330 sq. ft.
Total area: 2580 sq. ft.

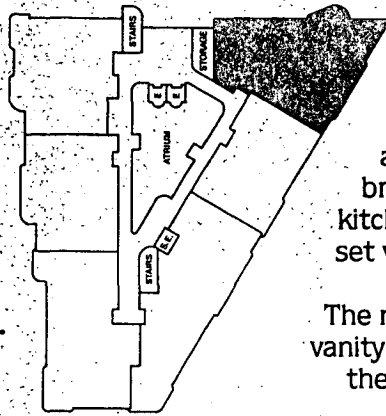

Balconies on two sides add an extra dimension to this corner home, which offers three bedrooms and three full baths. In the morning, you'll watch the sailboats gliding across Venetian Bay from your balcony off the breakfast area adjoining the efficient U-shaped kitchen, while in the evening you'll watch the sun set vividly over the Gulf from your balcony off the large living room and adjacent dining area. The master bedroom suite includes a double bowl vanity area as well as two large walk-in closets, and the third bedroom can be a cozy den if you wish.

