

Pepper Tree Site Plan

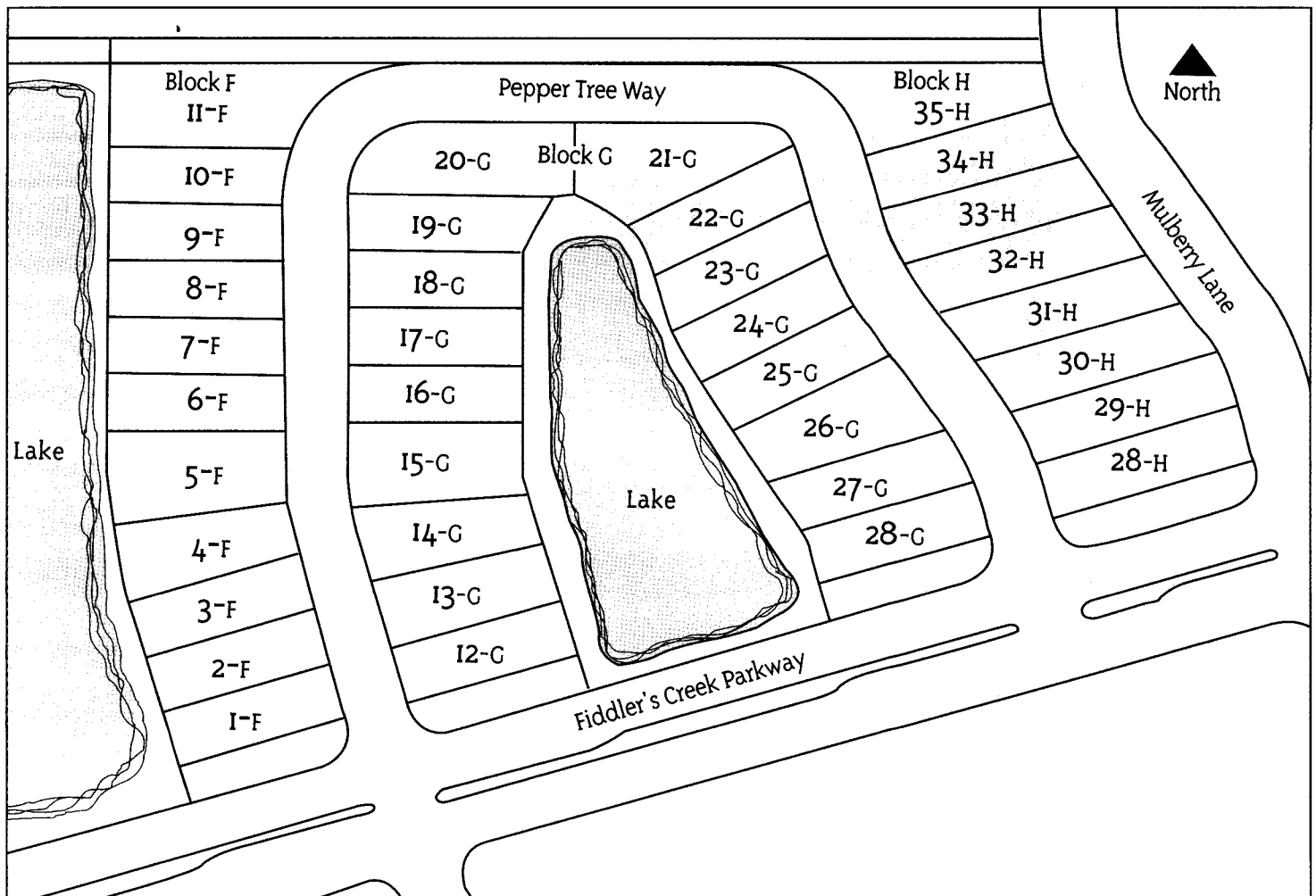

The Site Plan for the development of the Village of Pepper Tree at Fiddler's Creek represents the current plan of the Developer, CBFC Development Joint Venture. This Site Plan is subject to change without notice as a result of changing market conditions, requirements of governmental agencies, and buyers' expectations and needs. As this plan is conceptual in nature, it is not to scale, does not disclose all easements, reservations or limitations of record. This Site Plan is neither a zoning map nor engineered survey of Pepper Tree, but serves only as the Developer's guidelines for development, until next revised.

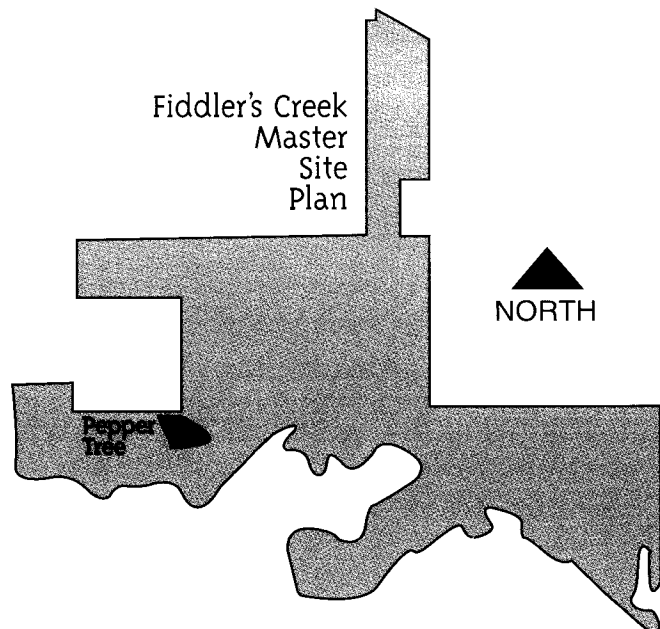

Fiddler's CreekSM



A Gulf Bay CommunitySM

On the fun side of Naples, SR 951, on the way to Marco Island.
 8152 Fiddler's Creek Parkway, Naples, FL 34114.
 (941) 732-9300. (800) 434-6660. Fax: (941) 732-9311
 Internet: www.fiddlerscreek.com
 E-Mail: info@fiddlerscreek.com

Fiddler's Creek Realty Inc. Licensed Real Estate Broker. All features, amenities and prices are subject to change without notice. All club facilities and the private golf course as presently proposed are not constructed nor will all proposed facilities be located within the property encompassed in the Fiddler's Creek PUD. Development and construction of these facilities is contingent upon receipt of all applicable government permits and approvals. Ownership of property within Fiddler's Creek does not entitle an Owner to any right, title, interest or otherwise to use all planned Club facilities but rather an opportunity to join, subject to the payment of dues, fees and applicable regulations. Contact Fiddler's Creek Realty, Inc., for specific information regarding any proposed facility.

