

Mulberry Row Site Plan

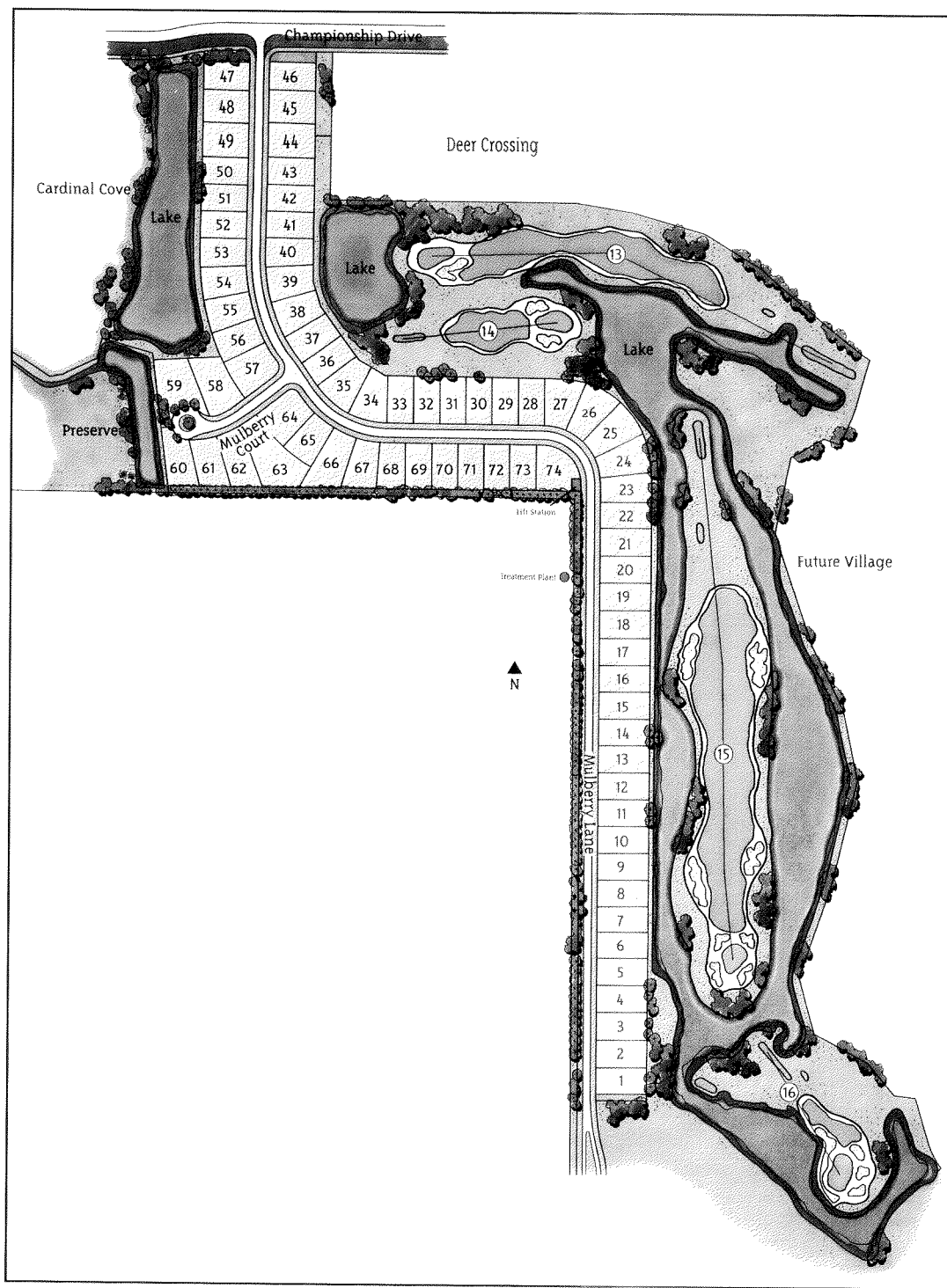

This Site Plan for the development of the Village of Mulberry Row at Fiddler's Creek represents the current plan of 951 Land Holdings Joint Venture. This Site Plan is subject to change without notice as a result of changing market conditions, requirements of governmental agencies, and buyers' expectations and needs. As this plan is conceptual in nature, it is not to scale, does not disclose all easements, reservations or limitations of record. This Site Plan is neither a zoning map nor engineered survey of Mulberry Row, but serves only as the Developer's guidelines for development, until next revised.

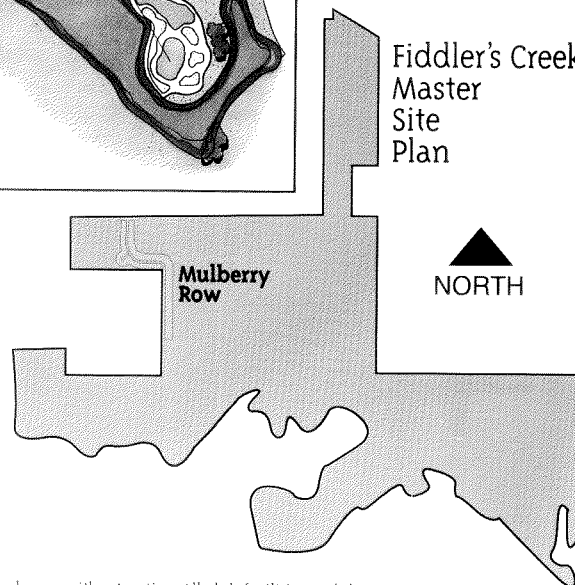

Fiddler's Creek



A Gulf Bay Community

On the fun side of Naples, SR 951, on the way to Marco Island.

8152 Fiddler's Creek Parkway, Naples, FL 34114.

(941) 732-9300. (800) 434-6660. Fax: (941) 732-9311.

Internet: www.fiddlerscreek.com

E-Mail: info@fiddlerscreek.com

Fiddler's Creek Realty, Inc. Licensed Real Estate Broker. All features, amenities, prices and availability are subject to change without notice. All club facilities and the private golf course as presently proposed are not constructed nor will all proposed facilities be located within the property encompassed in the Fiddler's Creek PUD. Development and construction of these facilities is contingent upon receipt of all applicable government permits and approvals. Ownership of property within Fiddler's Creek does not entitle an Owner to any right, title, interest or otherwise to use all planned Club facilities but rather an opportunity to join, subject to the payment of dues, fees and applicable regulations. Contact Fiddler's Creek Realty, Inc., for specific information regarding any proposed facility. Construction of single family homes at Mulberry Row will be by various independent builders and neither the obligations nor quality of work is warranted or guaranteed by either Fiddler's Creek Realty, Inc., or 951 Land Holdings Joint Venture.

