

GRAND PARLOUR III

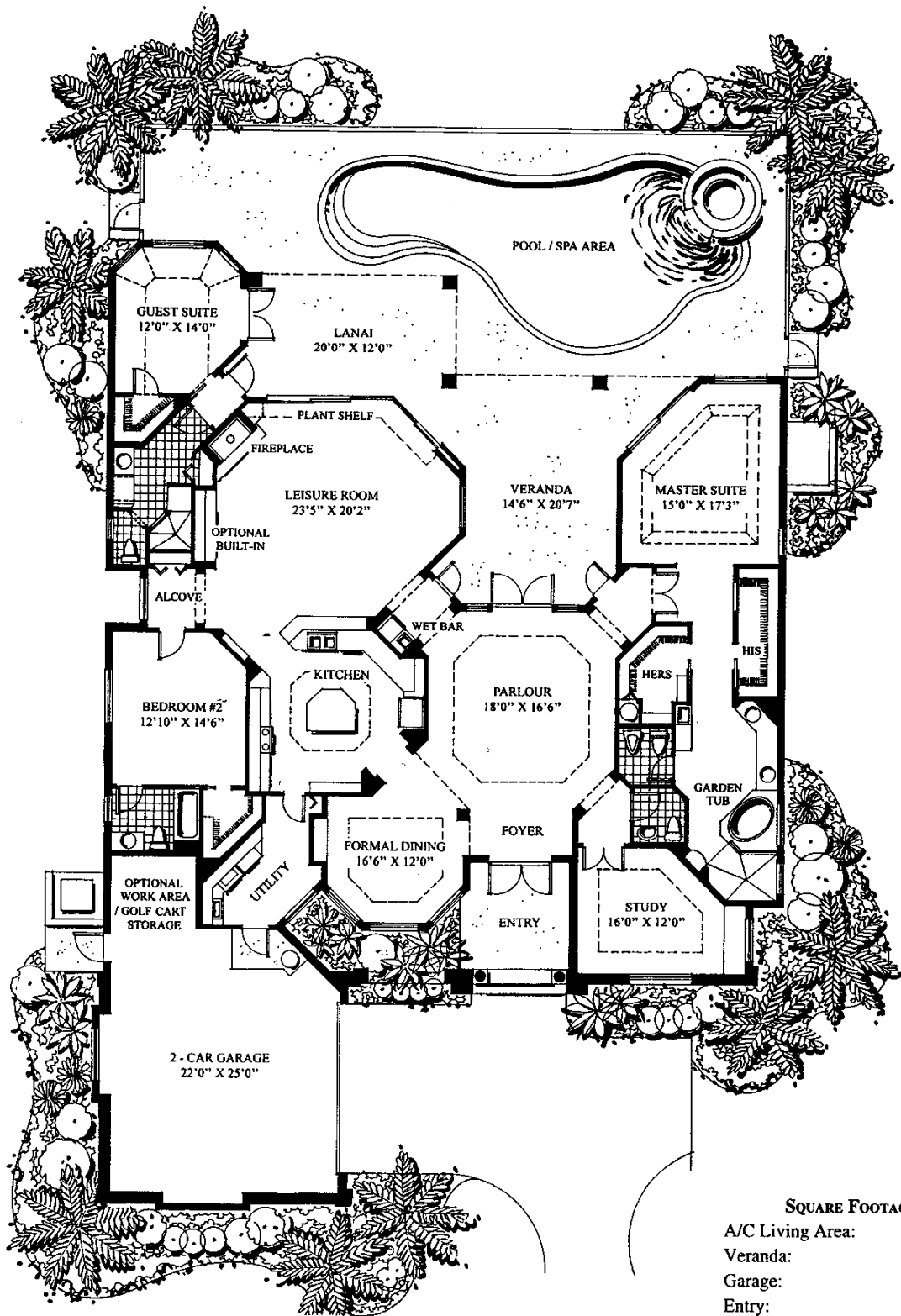

The Mews
AT GREY OAKS



SQUARE FOOTAGE

A/C Living Area:	3,058'
Veranda:	629'
Garage:	658'
Entry:	188'
TOTAL:	4,533'

Dimensions approximate. Information herein believed to be accurate but not warranted.

Developed by Country Homes of Collier County, Inc. Marketed exclusively by Grey Oaks Realty, Inc.