

COURTYARD HOME

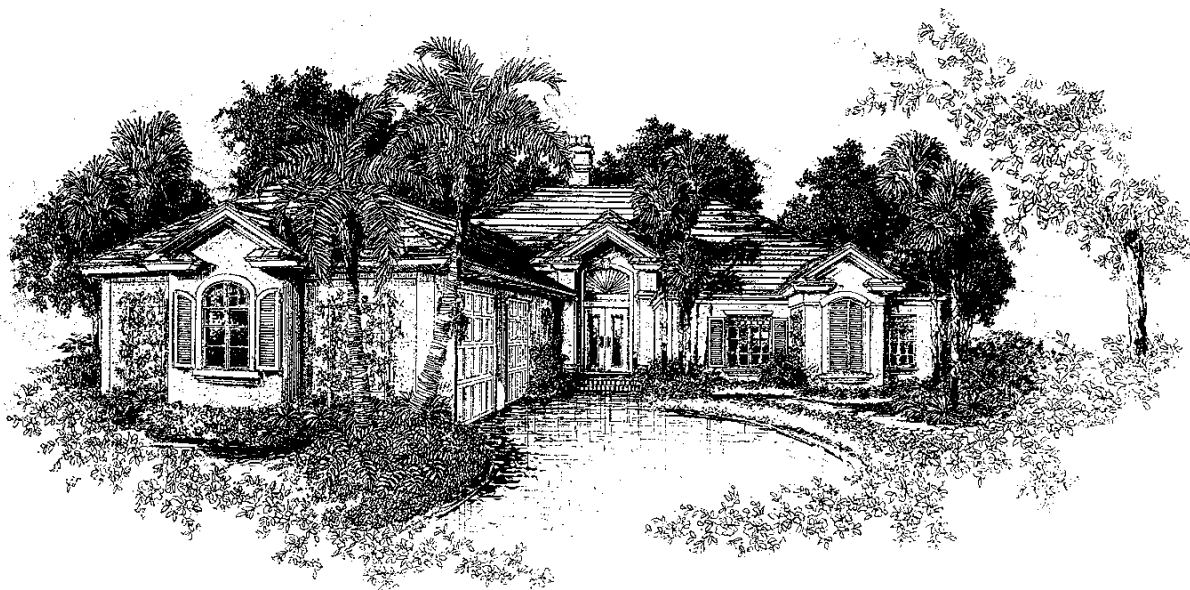

The Mews
AT GREY OAKS

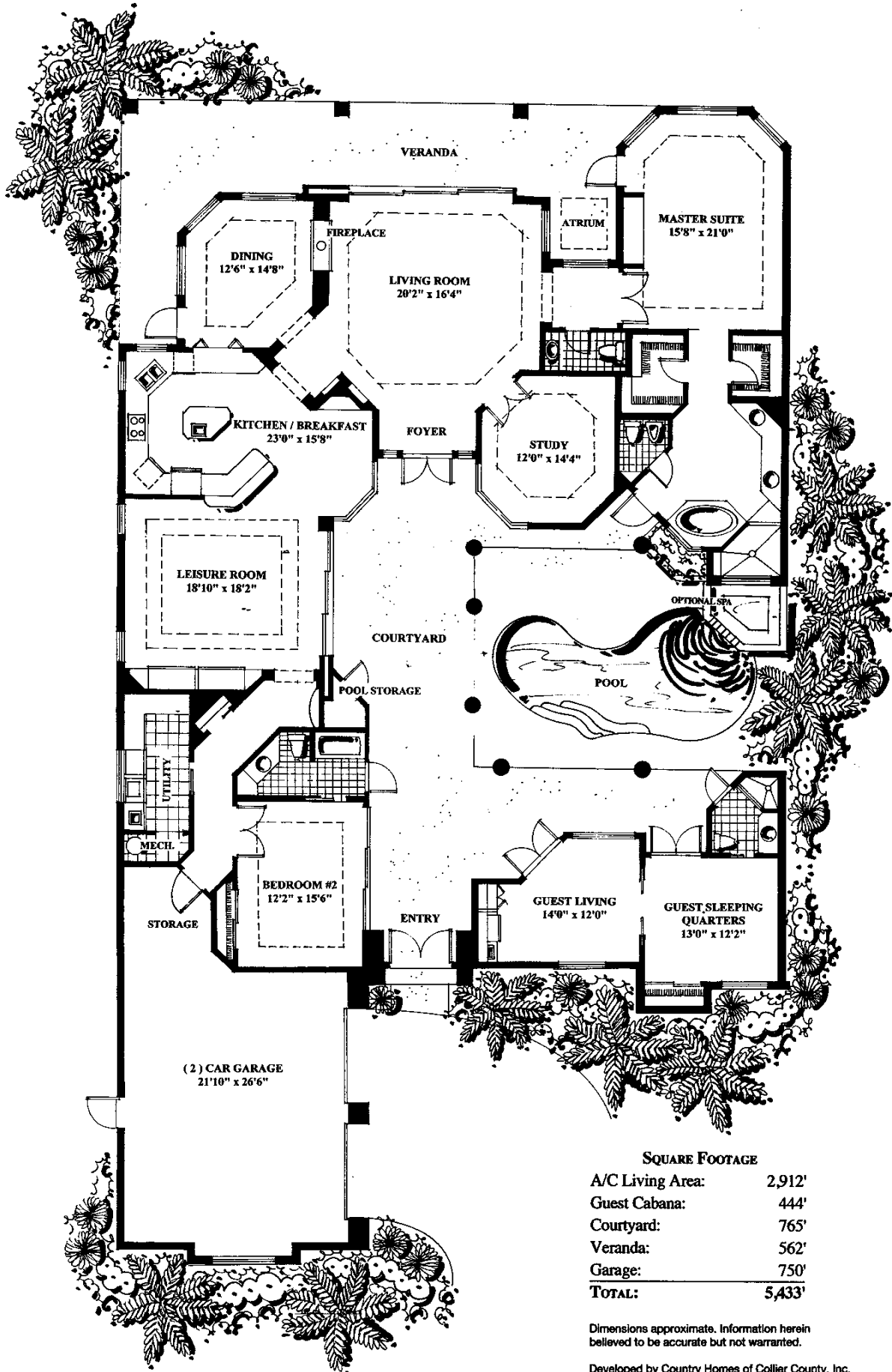

SQUARE FOOTAGE

A/C Living Area:	2,912'
Guest Cabana:	444'
Courtyard:	765'
Veranda:	562'
Garage:	750'
TOTAL:	5,433'

Dimensions approximate. Information herein believed to be accurate but not warranted.

Developed by Country Homes of Collier County, Inc.
Marketed exclusively by Grey Oaks Realty, Inc.