

IMPERIAL GARDENS, A CONDOMINIUM

PHASE I

I

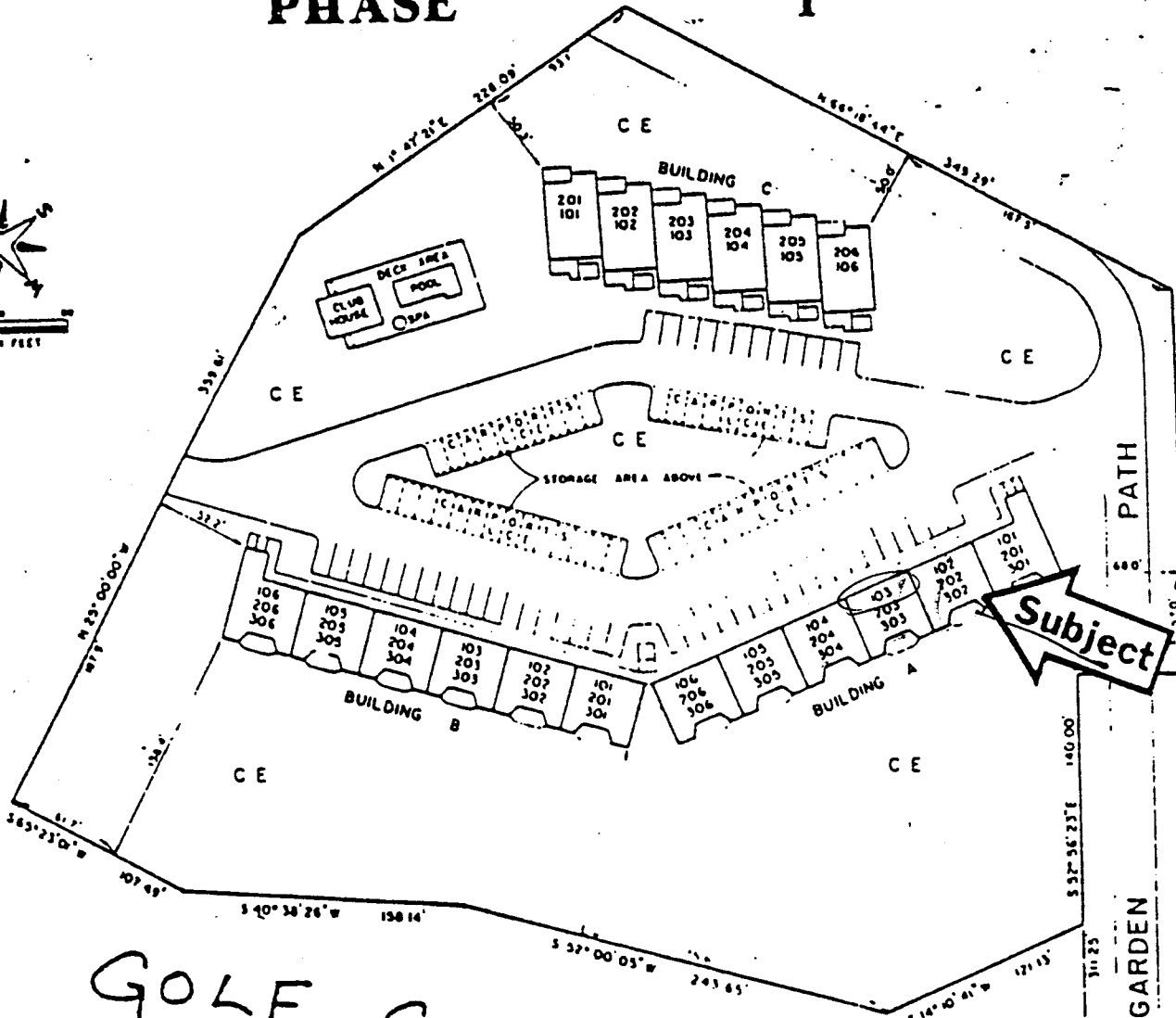

Subject

LEGAL DESCRIPTION PHASE I
A PORTION OF LAND LYING IN SECTION 14, TOWNSHIP 48 SOUTH, RANGE 25 EAST, COLLIER COUNTY, FLORIDA, BEING MORE PARTICULARLY DESCRIBED AS FOLLOWS: FROM THE SOUTHWEST CORNER OF SAID SECTION 14, A DISTANCE OF 299.67 FEET, THENCE S 89° 59' 10" E A DISTANCE OF 111.21 FEET, THENCE N 14° 10' 41" E A DISTANCE OF 733.84 FEET, THENCE N 14° 10' 41" E A DISTANCE OF 233.00 FEET, THENCE N 14° 10' 41" E A DISTANCE OF 111.21 FEET, THENCE S 82° 56' 23" E 114.68 FEET TO THE POINT OF BEGINNING OF THE LAND DESCRIBED THENCE S 52° 56' 23" E 311.25 FEET, THENCE N 52° 56' 23" E 114.68 FEET, THENCE S 89° 59' 10" E 111.21 FEET, THENCE N 14° 10' 41" E 733.84 FEET, THENCE S 82° 56' 23" E 114.68 FEET TO THE POINT OF BEGINNING CONTAINING 3.73 ACRES MORE OR LESS.

POB FOR PHASE I

POB FOR EASEMENT

GOLF COURSE

ROAD TO CLUBHOUSE

NOTE
CE DENOTES COMMON ELEMENT
LCE DENOTES LIMITED COMMON ELEMENT
ALL 100+ UNITS ON FIRST FLOOR
ALL 200+ UNITS ON SECOND FLOOR
ALL 300+ UNITS ON THIRD FLOOR

SURVEY & PLOT

EXHIBIT SHEET

BELLAMY EN

LESS EGRESS AND UTILITY EASEMENT
IN SECTION 14, TOWNSHIP 48 SOUTH, RANGE 25 EAST, COLLIER COUNTY, FLORIDA,
AS DESCRIBED AS FOLLOWS:
OWNER OF SAID SECTION 14, RUN N 00° 00' 30" E, ALONG THE WEST LINE OF SAID
SECTION 14, A DISTANCE OF 111.21 FEET, THENCE N 14° 10' 41" E
A DISTANCE OF 733.84 FEET, THENCE S 89° 59' 10" E A DISTANCE OF 111.21 FEET,
THENCE N 14° 10' 41" E A DISTANCE OF 233.00 FEET, THENCE N 14° 10' 41" E
A DISTANCE OF 111.21 FEET, THENCE S 82° 56' 23" E 114.68
FEET TO THE POINT OF BEGINNING OF THE LAND HEREIN DESCRIBED THENCE S 52° 56' 23" E
311.25 FEET, THENCE N 52° 56' 23" W 311.25 FEET TO A POINT ON A CURVE,
ON THE ARC OF THE CURVE CONCAVE TO THE EAST 47.12 FEET, SAID CURVE HAVING
A CHORD OF 42.43 FEET, AND A CHORD BEARING OF N 7° 56' 23" W TO THE SOUTHWEST
CORNER OF SAID SECTION 14, THENCE ALONG SAID RIGHT-OF-WAY S 37° 03' 37" W 120.00
FEET, THENCE ALONG THE ARC OF A CURVE CONCAVE TO THE SOUTH 47.12 FEET,
CHORD OF 30 FEET, CHORD OF 42.43 FEET, AND A CHORD BEARING OF N 82° 03' 37"
E 196.37 FEET TO THE POINT OF BEGINNING.