

BOLERO

Shown with spa option
 4 Bedroom, 2 Bath
 Air-Conditioned Living Area 1,865 Sq. Ft.

© COPYRIGHT BY SAN RAFAEL BUILDING CORPORATION AND THE NEUBEK GROUP ARCHITECTS and the aforementioned hereby expressly reserve their copyrights and other property rights in this drawing. The drawing is not to be copied or changed in whole or parts whatsoever nor assigned to any party without first obtaining written permission from the San Rafael Building Corporation and the Neubek Group.

All dimensions, features and specifications are approximate and subject to change without notice.

Artist's Conception

SCREENED PORCH OPTIONS

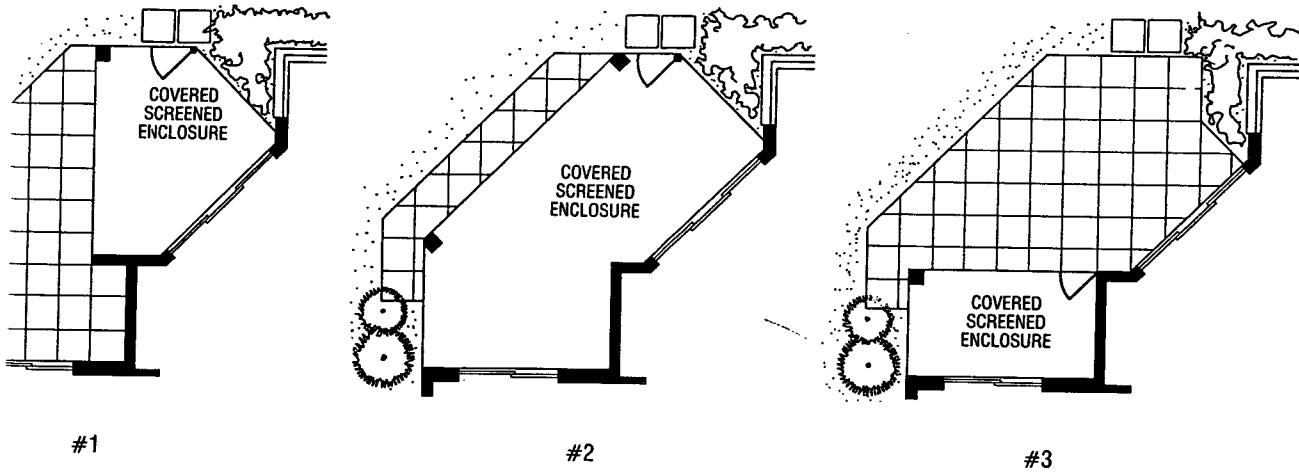

FLOORPLAN OPTIONS

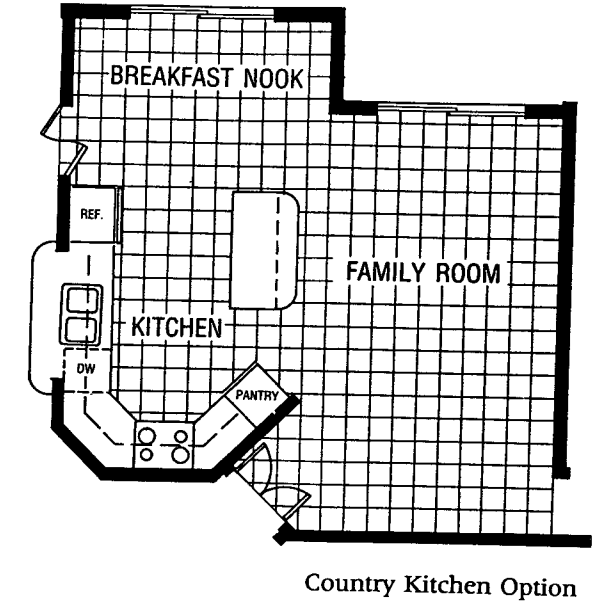

PATIO, POOL AND SPA OPTIONS

