

DIVCO CONSTRUCTION

1307 LITTLE BLUE HERON COURT, SITE 23

3 BEDROOM, 3 1/2 BATH
5,179 SQUARE FEET TOTAL AREA
3,765 SQUARE FEET LIVING AREA

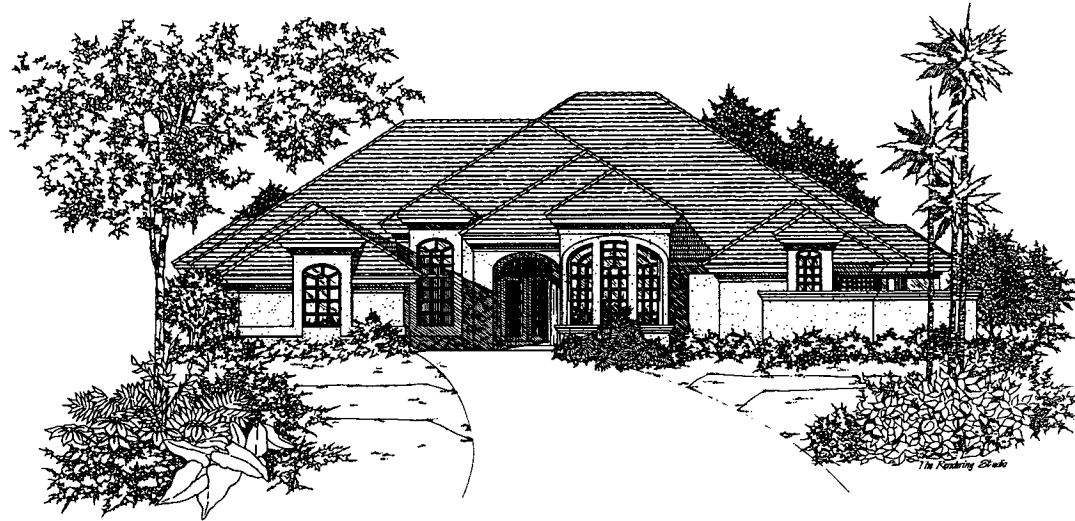

This nine-room residence by Divco Construction Corp. incorporates a truly unique floorplan. A double door entry opens to the foyer, which is highlighted by an enclosed garden and fountain area. The living room features a fireplace, opens to the veranda and shares a view of the garden and fountain as well.

The gathering room with a custom-built entertainment center opens to its own private veranda. A fully equipped island kitchen will provide easy access to the formal dining room and features a breakfast room with views to the pool area and golf course. The luxurious master suite features a private retreat, its own entertainment center, his-and-hers walk-in closets, and opens to the veranda and pool area.

Divco Construction has been building custom homes in Southwest Florida since 1979. Divco has homes in the premier communities of Pelican Bay, Pelican Landing and Gateway. Stephen Kaufmann, who heads Divco, has been a leader in the construction of single-family homes.

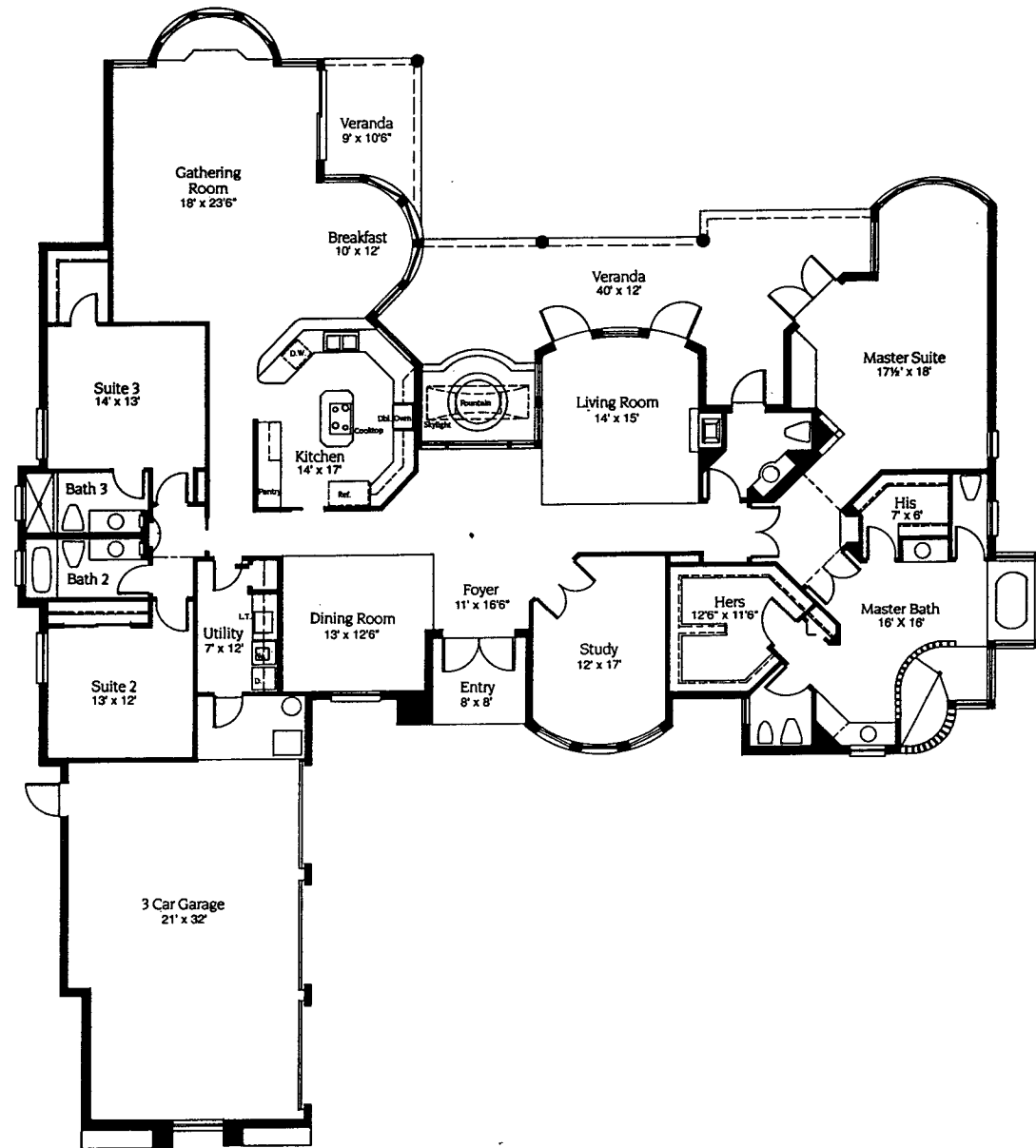

All renderings and floorplans are conceptual and for illustrative purposes only, and are subject to change without notice. Please refer to each homebuilder for complete home plans and construction specifications.