

PHOENIX HOMES OF SOUTHWEST FLORIDA

1301 LITTLE BLUE HERON COURT, SITE 22

4 BEDROOM, 3 1/2 BATH
4,638 SQUARE FEET TOTAL AREA
3,482 SQUARE FEET LIVING AREA



Phoenix Homes has designed a residence with the accent on comfort and convenience, with the main rooms accented toward outdoor views of the landscaped patio, pool and spa area and lake.

Tile flooring in all living areas projects an elegant motif, accented by plush carpeting in each of the four bedrooms. The spacious master suite opens to the lanai to offer stunning views while insuring the utmost privacy. The ample kitchen and food preparation area open up to the elongated leisure room, oriented toward the entertainment center as well as the glass walls. Three Palladian-styled windows provide ample sunlight for the study.

Richard Blosser, a resident of Pelican Bay, heads Phoenix Homes. He believes in a hands-on approach, and personally inspects every phase of construction. A Phoenix Home blends creativity of design with quality of craftsmanship that prove his meticulous penchant for detail.

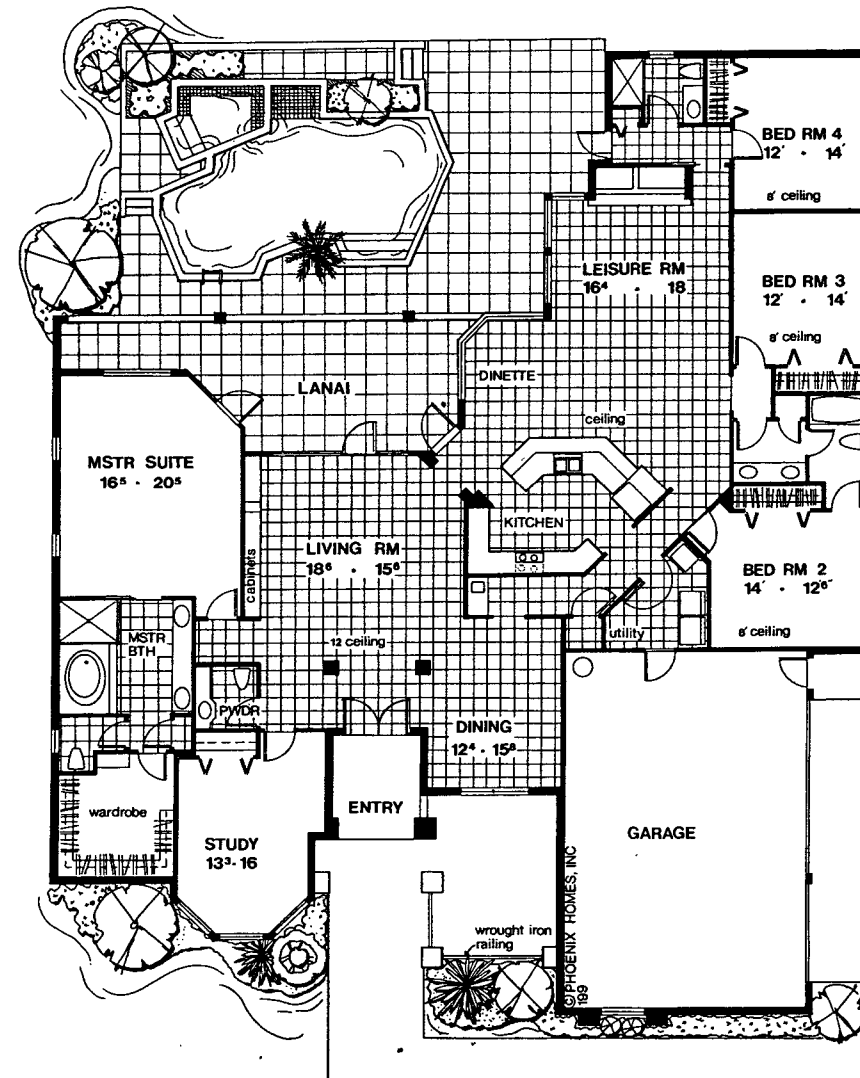

All renderings and floorplans are conceptual and for illustrative purposes only, and are subject to change without notice. Please refer to each homebuilder for complete home plans and construction specifications.