

# SCHROEDER HOMES

1300 LITTLE BLUE HERON COURT, SITE 21

3 BEDROOM, 3 1/2 BATH  
5,298 SQUARE FEET TOTAL AREA  
3,658 SQUARE FEET LIVING AREA

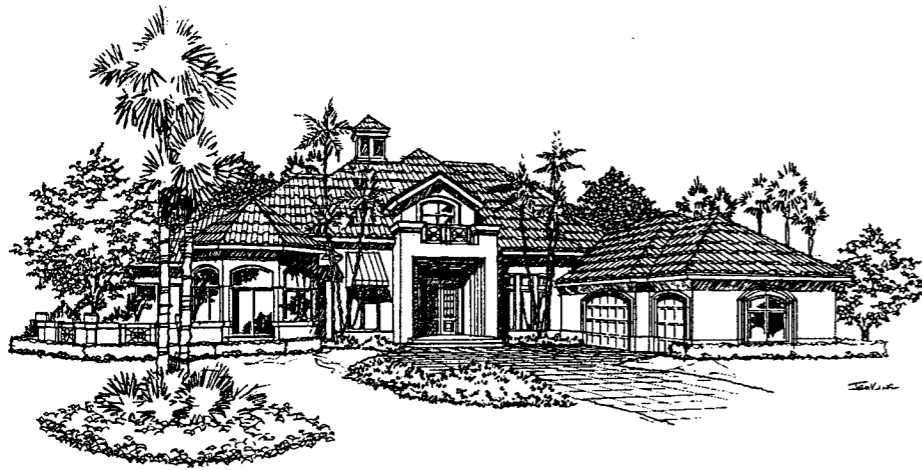

*This home is custom designed to capture the magnificent views of the tropical foliage and sparkling lake. The breakfast room, family room, living room, library and master suite all afford views to the expansive lanai, pool and spa area and lake beyond. The master bedroom opens to a private garden courtyard, while the living room, with its octagonal design and fireplace, is the entertainment center of the residence.*

*Outside, family and guests will enjoy the pool entertainment center equipped with a cook-top range, refrigerator and sink. Inside, the fully equipped island kitchen with breakfast area will be a gourmet's delight.*

*The Schroeder Homes vision is a pursuit of many ideals. It is the commitment to create unequalled homes and to shun compromise. In addition, it is the dedication to deliver an unsurpassed home-building experience to the customer that is the Schroeder Homes trademark. Built upon the formidable accomplishments of more than a decade of quality homebuilding, each Schroeder home is designed to add new luxury and refinement to your lifestyle.*

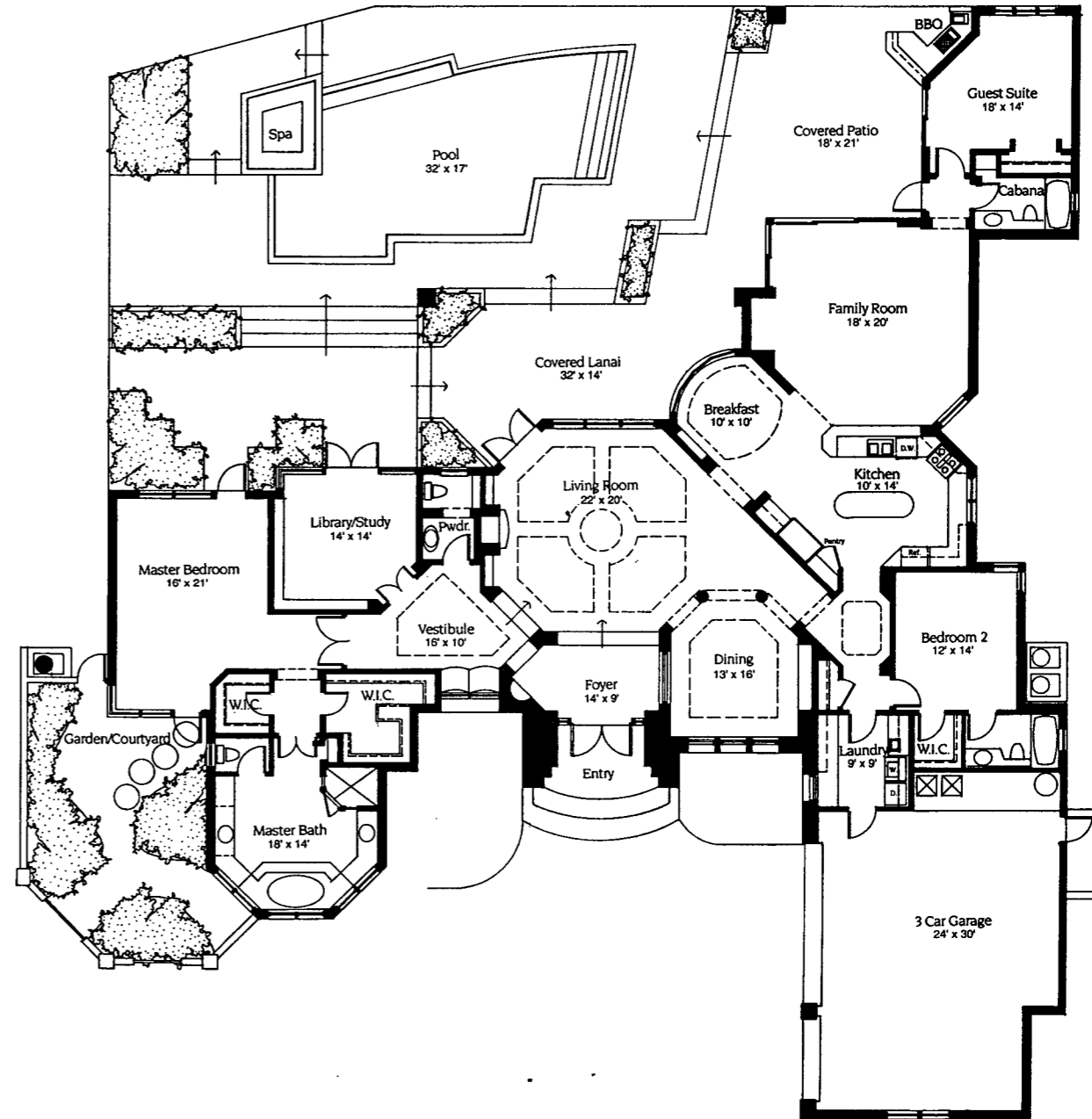

All renderings and floorplans are conceptual and for illustrative purposes only, and are subject to change without notice. Please refer to each homebuilder for complete home plans and construction specifications.